



CERTIFICATE OF COMPLIANCE

Date: October 18, 2019

Certificate no. FAC-917 Rev. 1

Apex 150 Half Round Gutter (Vic)

Specifications of items certified: As per drawing no. FA-APX-917 Rev. 1

Description of items certified: 150 Half Round Gutter (with and without front slots)

Aspects of gutter certified: Effective cross section areas, nominal flow capacities and continuous front slots overflow capacities shown in drawing number FA-APX-917 Rev. 1

BASIS OF CERTIFICATION

The following documents were referred to in making this certification:

- a. NCC2019 Volumes 2 and 3
- b. AS/NZS 3500.3:2018

CERTIFICATION

I certify that the:

- a. Effective cross-section areas
- b. Nominal flow capacities; and
- c. Continuous front slot overflow capacity

of the gutters shown in drawing number FA-APX-917 Rev. 1, comply with the requirements of the Codes and Standards listed above.

CONDITIONS OF CERTIFICATION

The conditions of certification are as follows:

- a. Gutter slope = 1:500 (or steeper)
- b. Minimum vertical distance from top of fascia to bottom edge of front slots = 25mm (for slotted gutters)
- c. Gutter should be installed in accordance with NCC2019 requirements

Milton J. Fernandes
FIEAust CPEng NER APEC Engineer IntPE(Aus) RPEQ4112 VBA-RBP-EM 63270
Chartered Professional Engineer
Principal Engineer
milton@fernandes.net.au
Mobile: 0411 760 565



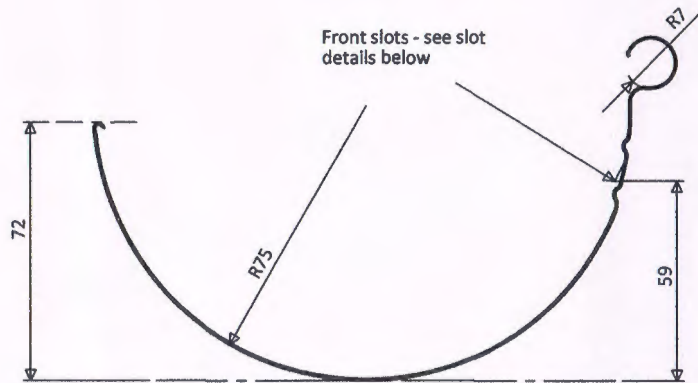

Material - 0.42 G550 Colorbond or Zincalume

(Note -All gutter dimensions are approximate)

150 Half Round Gutter Profile

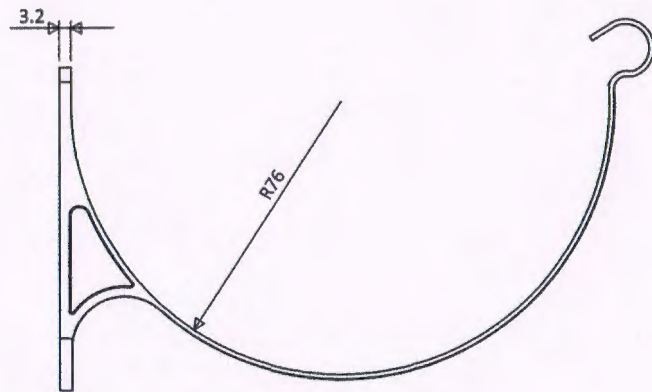

Material - Die-cast Aluminium Alloy

150 Half Round Gutter Bracket (with built in 3.2mm back gap spacer)

*MJF.
18/10/19.*

 ENGINEERS AUSTRALIA	Milton J. Fernandes RPEQ, FIEAust CPEng Chartered Professional Engineer Membership No. 920595 Engineers Australia
	Registered Professional Engineer of Queensland RPEQ 4112

Effective cross-section area (mm ²)	Gutter flow capacity (L/s)	Gutter description	Gutter slope	Front slot overflow capacity (L/s/m)
6800	2.61	150 Half Round Gutter - No front slots	1:500	-
5000	1.68	150 Half Round Gutter - with front slots	1:500	0.39

Table: 150 Half Round Flat Back Gutter -Cross Section Areas and Flow Rates

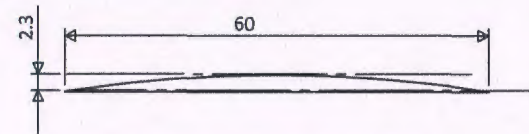

Slot opening area 92mm² per slot or 968mm² per lineal meter
Slot details



CONSULTING ENGINEERS
 Fernandes & Associates Pty. Ltd
 ABN 56 059 624 565
 1/141 Campbell St. Bowen Hills Qld 4006
 Email: info@fernandes.net.au
 Website: www.fernandes.net.au
 Telephone: (07) 3852 1371

Client:
Apex Building Products Pty Ltd

150 Half Round Gutter (Victoria)

Gutter Profile and Hydraulic Capacity

Dwg. No. FA-APX-917

Rev. 1

DATE

18/10/2019

Sheet 1 of 1